

HISTORY

The TCU neighborhood gets its name from the major land owner in the area, Texas Christian University. The original grantees were Maria Josepha Arocha in 1875, and John W. Asbury in 1863. The university began in Fort Worth in 1873, but left due to the raucous character of this western town. In 1910, the college returned, lured by an offer of 56 acres and \$200,000. Fort Worth's population in the 1910 Census was 73,312, and TCU was then located a long way from the city. The presence of the school encouraged development to the southwest as the street car line was routed to the campus, and streets were paved soon after that. The area was not annexed by the city until 1922.

The areas to the east of the present campus, including what is known as Park Ridge and Forest Park Village, have legal descriptions of Frisco Heights, platted in 1906, and Prospect Heights, platted in 1890, but are commonly known as the TCU area. TCU was an early owner of some of that land in 1929, but sold it to individuals

soon after that. Part of the area was occupied as early as 1907 with many lots being purchased before 1910. The Fort Worth Development Company began developing some of the land in 1908. One early owner was the McCart family. The area was annexed by Fort Worth in 1922.

In 1914, Fort Worth was made a mobilization point for the volunteer army if peace negotiations fell through and President Wilson declared war against Mexico. Major Davis picked out the "prairie" near Forest Park as an area where large bodies of soldiers could be placed and have a pure drinking water supply at hand, as well as surface water for stock, washing and other purposes.

In 1923, the City of Fort Worth developed the Worth Hills Golf Course. In 1962, needing more campus space, TCU's President, Dr. M.E. Sadler, made a trade with the City. He agreed to pay a large sum for the golf course so that the city could buy land near Benbrook Lake for a municipal course, if the

city would pay an equal sum to make a boulevard around the new campus area. This boulevard is now part of Stadium Drive and Bellaire Drive South, and the old golf course is where the TCU sorority and fraternity dorms and the soccer field, baseball stadium and track fields are now located.

On the east side of the TCU area, Paschal High School occupies the building which was originally Southwest Fort Worth Junior High School, built in 1935, and later called W.P. McLean Junior High School. It was remodeled and enlarged in 1955 to become Paschal. McLean moved to Stadium Drive, and Technical High School took over the old Paschal building on Cannon St.

North, west and south of the TCU campus are sometimes called the TCU area also, but are properly listed as University Place, University West, Colonial, Bellaire and Bluebonnet Hills neighborhoods.

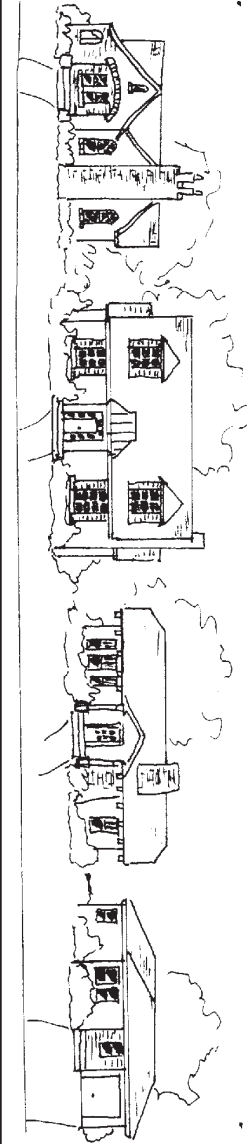

TCU (Includes Park Ridge and Forest Park Village)

Greater Fort Worth Association of REALTORS®

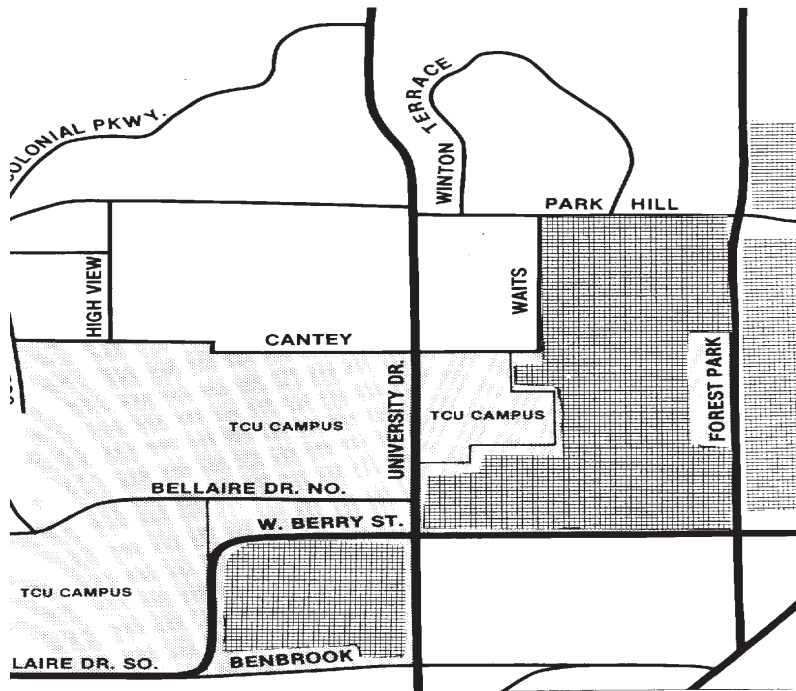

This information was conceived, researched and written by Wini Klein, REALTOR®, for the Greater Fort Worth Association of REALTORS®, with assistance from the City of Fort Worth Planning Department, Historic Preservation Council for Tarrant County, Historic Fort Worth, Inc., Texas Christian University, Junior League, Fort Worth Independent School District, Tarrant County Tax Office, League of Neighborhoods and encouragement from the Fort Worth Chamber of Commerce.
© 1998, 2008, Wini Klein

SCHOOLS

Elementary
Tanglewood, 3060 Overton Park W., 817-922-6815 (West of University Dr.)
Lily B. Clayton, 2000 Park Place, 817-922-6660 (East of University Dr.)
Middle
W.P. McLean, 3816 Stadium Dr., 817-922-6830
High School
R.L. Paschal, 3001 Forest Park Blvd., 817-922-6600

NEIGHBORHOOD DESCRIPTION

The majority of homes in this area are typical of those built in the early 20s and 30s. They are small cottages of varied construction with either detached garages in the rear or none. The lots are small. East and north of Paschal most homes are frame with siding and many would be considered tract housing. Some of the area has sidewalks, but most do not. Along Sandage and McCart where there were apartments and duplexes, T.C.U. has purchased the land and is building graduate student and Brite Divinity School student residential housing. The majestic structure of St. Stephen's resbyterian Church dominates the area.

OTHER INFORMATION

Nearest Fire Station: 3501 South Hills Ave., 817-871-6800, emergencies 911
Nearest medical facilities: Baylor All Saints Medical Center, 1400 Eighth Ave., 817-927-6102
Nearest Post Office: 2600 Eighth Ave., 817-924-0673
Nearest grocery shopping: Westcliff Center, Berry Street.
Nearest Mall: Hulen Mall
Nearest Park: Forest Park
City Council District Number: 9
School District Number: 5
Voting Precinct Number: 1081, 1298, 1108, depending on location of residence.

FORT WORTH FACTS

History: Fort Worth was established as a frontier army post in 1849 and named for Gen. Wm. Jenkins Worth. The outpost became a stopping place on the Old Chisholm Trail and a shipping point for great herds of cattle being sent to northern markets.

Population: 700,000
Land Area: 293 square miles
Altitude: 670 feet above sea level
Weather: Normal sunshine averages 250 days a year
Average mean temperature: 65.5 F
Annual avg. precipitation 29.46 in.

Medical Facilities: 46 hospitals
Education: 66 elementary schools, 19 middle schools, 12 high schools, 13 special education schools, 11 major private and parochial schools, 9 college and university campuses
Libraries: 1 main library with 1 regional library and 9 branches,
Museums: 11
Parks: 9,026 acres
Churches and Synagogues: more than 910 with 45 denominations
Communications: 1 daily newspaper, 2 weekly papers, 10 TV stations plus cable.